

# EVRIMA

## OUR FLAGSHIP YACHT

With up to 298 guests aboard *Evrima*, taking in the view from your suite's private terrace as you drop anchor off a scenic shoreline. From the aft Marina, you can explore by kayak or paddle board before heading ashore. Five restaurants and six lounges offer an array of culinary delights, while legendary service and luxurious amenities complete the onboard experience.

### SUITE CATEGORIES

- THE OWNER'S SUITES
- THE VIEW SUITES
- THE LOFT SUITES
- THE GRAND SUITES
- THE SIGNATURE MID SUITES
- THE SIGNATURE SUITES
- THE TERRACE MID SUITES
- THE TERRACE SUITES
- ACCESSIBLE SUITES
- CONNECTING SUITES
- CONVERTIBLE SUITES\*

### SPECIFICATIONS

- GUEST CAPACITY \_\_\_\_\_ 298
- OFFICER AND CREW \_\_\_\_\_ 246
- TOTAL SUITES \_\_\_\_\_ 149
- TONNAGE \_\_\_\_\_ 26,500
- LENGTH \_\_\_\_\_ 624 FEET / 190 METERS
- WIDTH \_\_\_\_\_ 78 FEET / 23.8 METERS
- GUEST DECKS \_\_\_\_\_ 8
- BUILT \_\_\_\_\_ 2021
- YACHT'S REGISTRY \_\_\_\_\_ MALTA

\*\*Select Terrace Suites have the ability to convert into an expanded living and dining area or remain a second bedroom when connected to the adjacent suite.

DECK 10

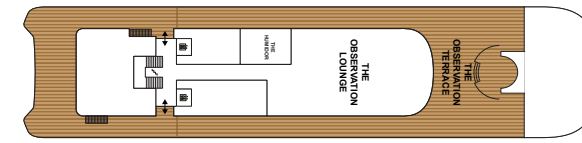

DECK 9

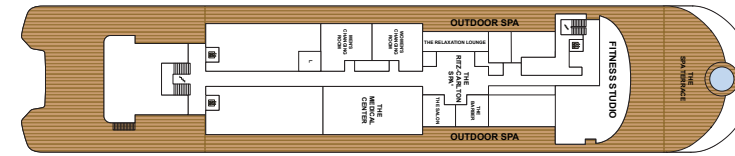

DECK 8

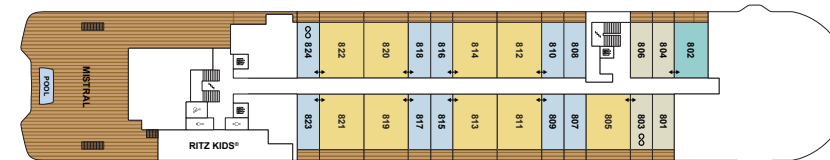

DECK 7

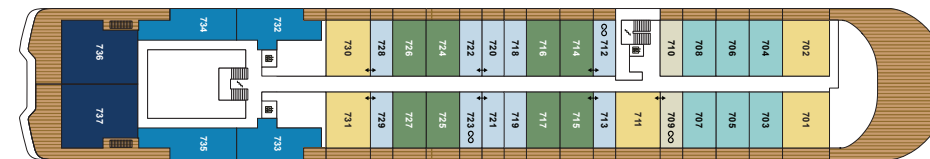

DECK 6

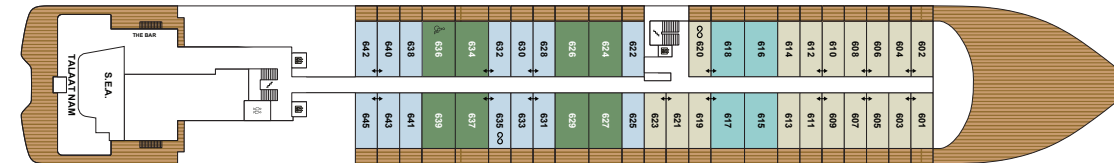

DECK 5

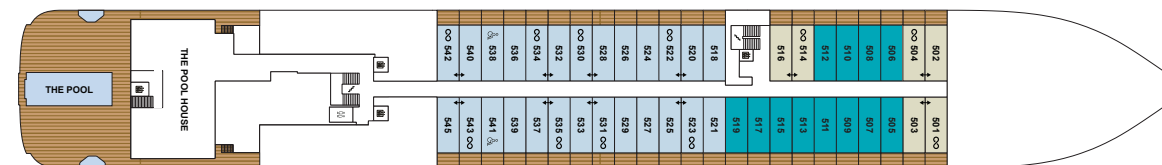

DECK 4

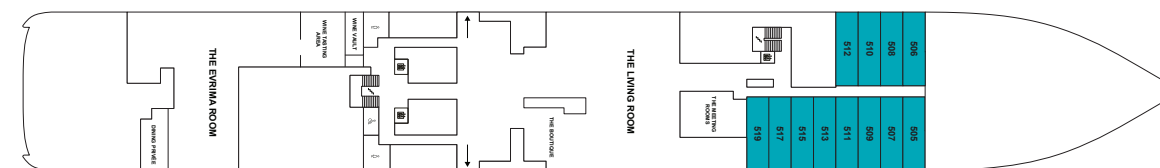

DECK 3

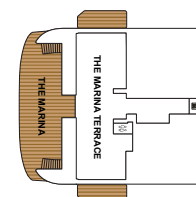

### DECK 10

- THE OBSERVATION LOUNGE
- THE OBSERVATION TERRACE
- THE HUMIDOR

### DECK 9

- THE GYM
- FITNESS STUDIO
- THE RITZ-CARLTON SPA®
- THE SPA TERRACE

### DECK 8

- THE BARBER / THE SALON
- LAUNDERETTE
- THE MEDICAL CENTER

### DECK 8

- MISTRAL
- RITZ KIDS®
- SUITES 801 – 824

### DECK 7

- SUITES 701 – 737

### DECK 6

- THE BAR
- S.E.A.
- TALAAAT NAM
- SUITES 601 – 645

### DECK 5

- THE POOL HOUSE
- THE POOL
- SUITES 501 – 545

### DECK 4

- THE MEETING ROOMS
- THE LIVING ROOM
- THE BOUTIQUE
- THE EVRIMA ROOM
- DINING PRIVÉE
- WINE VAULT
- WINE TASTING AREA
- 505 – 519 LOWER LEVEL

### DECK 3

- THE MARINA TERRACE
- THE MARINA